

READ BEFORE USE
LIRE AVANT UTILISATION
LEA ANTES DE USAR

Visit www.hamiltonbeach.com for our complete line of products and Use and Care Guides – as well as delicious recipes, tips, and to register your product online.

Rendez-vous sur www.hamiltonbeach.ca pour notre liste complète de produits et de nos manuels utilisateur – ainsi que nos délicieuses recettes et nos conseils.

Visite www.hamiltonbeach.com (EE. UU.) o www.hamiltonbeach.com.mx (México) para ver otros productos de Hamilton Beach o para contactarnos.

For Questions: 1.800.851.8900
For recipes, tips, product information and registration:
www.hamiltonbeach.com

Pour des questions : 1.800.267.2826
Pour des recettes, des conseils, des renseignements sur le produit et l'enregistrement :
www.hamiltonbeach.com

Para preguntas: 800 71 16 100
Para recetas, consejos, información del producto y registro:
www.hamiltonbeach.com.mx
Le invitamos a leer cuidadosamente este instructivo antes de usar su aparato.

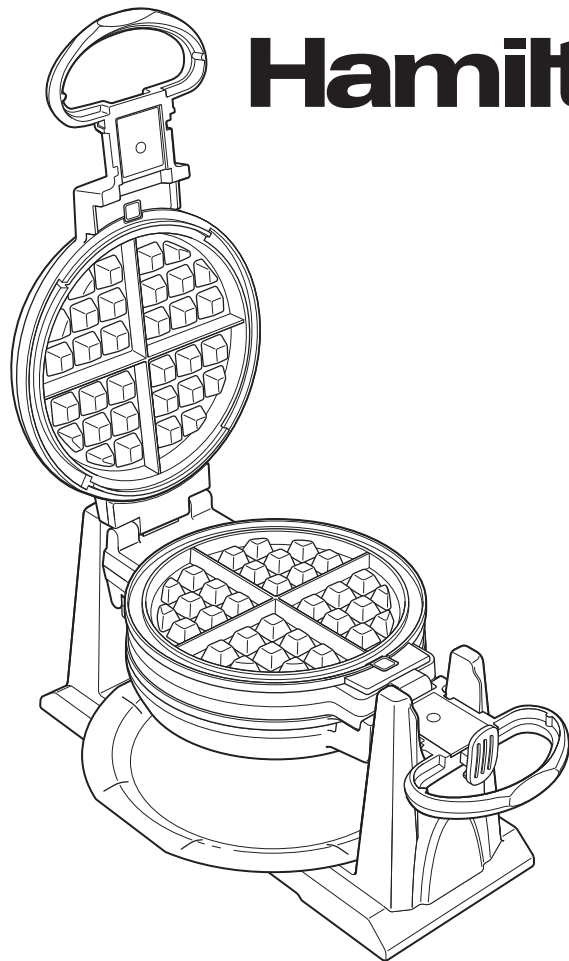

Hamilton Beach®

Double Flip
Waffle Maker
Gaufrier rotatif
double
Máquina para
hacer waffles
con doble vuelta

English 2

Français 10

Español 20

IMPORTANT SAFEGUARDS

When using electrical appliances, basic safety precautions should always be followed to reduce the risk of fire, electric shock, and/or injury to persons, including the following:

1. Read all instructions.
2. This appliance is not intended for use by persons (including children) with reduced physical, sensory, or mental capabilities, or lack of experience and knowledge, unless they are closely supervised and instructed concerning use of the appliance by a person responsible for their safety.
3. Close supervision is necessary when any appliance is used by or near children. Children should be supervised to ensure that they do not play with the appliance.
4. Do not touch hot surfaces. Use handles or knobs.
5. To protect against a risk of electrical shock, do not immerse cord, plug, or any part of the appliance in water or other liquid.
6. Unplug from outlet when not in use and before cleaning. Allow to cool before putting on or taking off parts and before cleaning.
7. Do not operate any appliance with a damaged supply cord or plug, or after the appliance malfunctions or has been dropped or damaged in any manner. Supply cord replacement and repairs must be conducted by the manufacturer, its service agent, or similarly qualified persons in order to avoid a hazard. Call the provided customer service number for information on examination, repair, or adjustment.
8. The use of accessory attachments not recommended by the appliance manufacturer may cause injuries.
9. Do not use outdoors.
10. Do not let cord hang over edge of table or counter, or touch hot surfaces, including the stove.
11. Do not place on or near a hot gas or an electric burner, or in a heated oven.
12. Extreme caution must be used when moving an appliance containing hot oil or other hot liquids.
13. Do not use appliance for other than intended use.
14. Do not use appliance unattended.
15. During use, provide 4 to 6 inches air space above, behind, and on both sides for air circulation.
16. Never remove the waffle with any kind of cutting device or other metallic kitchen utensil.
17. Always allow the appliance to cool before putting it away, and never wrap the cord around the appliance while it is still hot.
18. Do not operate the appliance by means of an external timer or separate remote-control system.
19.  **CAUTION: HOT SURFACE.** The temperature of accessible surfaces may be high when the appliance is operating.

SAVE THESE INSTRUCTIONS

Other Consumer Safety Information

This appliance is intended for household use only.

⚠ WARNING Electrical Shock Hazard: This appliance is provided with either a polarized (one wide blade) or grounded (3-prong) plug to reduce the risk of electric shock. The plug fits only one way into a polarized or grounded outlet. Do not defeat the safety purpose of the plug by modifying the plug in any way or by using an adapter. If the plug does not fit fully into the outlet, reverse the plug. If it still does not fit, have an electrician replace the outlet.

The length of the cord used on this appliance was selected to reduce the hazards of becoming tangled in or tripping over a

longer cord. If a longer cord is necessary, an approved extension cord may be used. The electrical rating of the extension cord must be equal to or greater than the rating of the appliance. If the appliance is of the grounding type, the extension cord should be a grounding-type, 3-wire cord. Care must be taken to arrange the extension cord so that it will not drape over the countertop or tabletop where it can be pulled on by children or accidentally tripped over.

To avoid an electrical circuit overload, do not use another high-wattage appliance on the same circuit with this appliance.

Parts and Features

To order parts:

US: 1.800.851.8900

www.hamiltonbeach.com

Canada: 1.800.267.2826

Mexico: 800 71 16 100

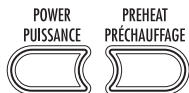

The red POWER Light comes on when appliance is first plugged in. This light will stay on until unit is unplugged.

The green PREHEAT Light comes on when the appliance has reached desired temperature. For best results, wait until green PREHEAT Light comes on before adding waffle batter.

The green light will cycle on and off during baking.

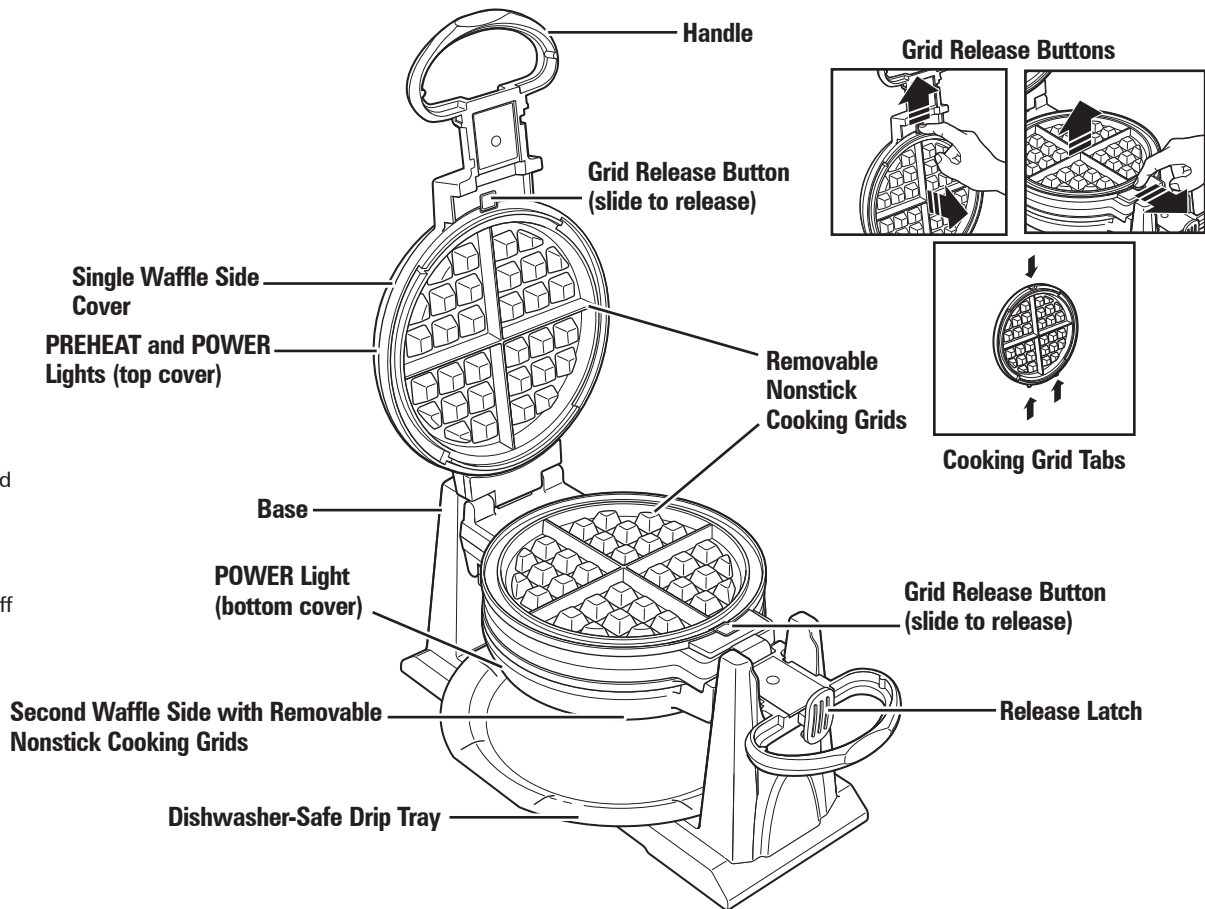

How to Make a Single Waffle

Before first use: Wipe Cooking Grids with a soapy, damp cloth. Rinse cloth; then wipe Grids again. Wipe or brush Grids with vegetable oil. This is only recommended before first use. Waffle browning will improve with each subsequent batch. Cooking Grids are dishwasher-safe.

⚠ WARNING Burn Hazard. Always use an oven mitt to protect hand when opening a hot waffle maker. Escaping steam can burn.

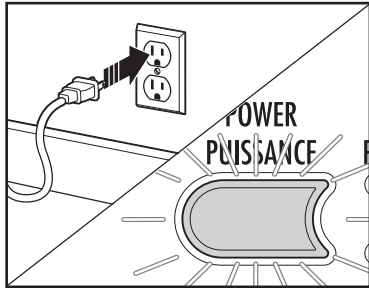

1. Plug into outlet. Red POWER Light will glow. Slide Drip Tray onto Base.

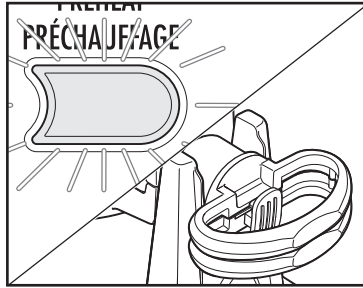

2. Preheat with Cover closed until green PREHEAT Light comes on. Pull Release Latch toward Handle to unlock.

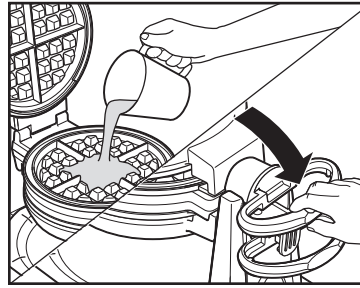

3. When making a waffle, lift Cover that says FILL THIS SIDE FIRST. Pour about 2/3 cup (125 ml) of batter into center of lower Grid, allowing batter to spread for even filling; then lower Cover. Be careful not to pour too much batter onto Grid to avoid overflow. **TIP:** Adjust amount of batter as needed.

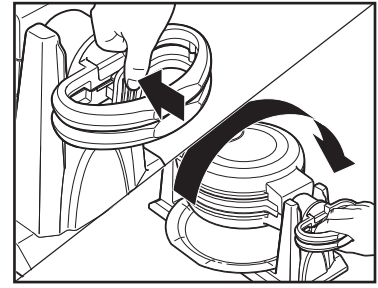

4. Within 10 seconds of closing Cover, push Release Latch toward Grid to lock and turn Handle clockwise to flip Waffle Maker. Waffle will be done in about 3 to 5 minutes, depending on recipe and when steaming begins to stop.

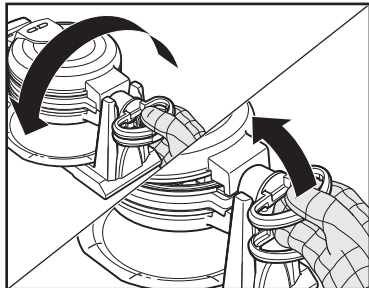

5. Using an oven mitt, pull Release Latch toward Handle to unlock. Raise Cover to check waffle doneness. If waffle is not done, lower Cover to continue cooking.

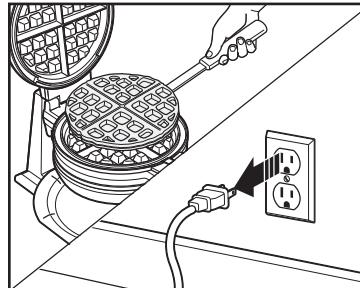

6. Remove waffle with plastic or wooden utensil. Never use metal. This will damage the nonstick coating of the appliance. Unplug unit when through cooking. Let cool.

How to Make Two Waffles

⚠ WARNING Burn Hazard. Always use an oven mitt to protect hand when opening a hot waffle maker. Escaping steam can burn.

Before first use: Wipe the Cooking Grids with a soapy, damp cloth. Rinse cloth; then wipe Grids again. Wipe or brush Grids with vegetable oil. This is only recommended before first use. Waffle browning will improve with each subsequent batch. Cooking Grids are dishwasher-safe.

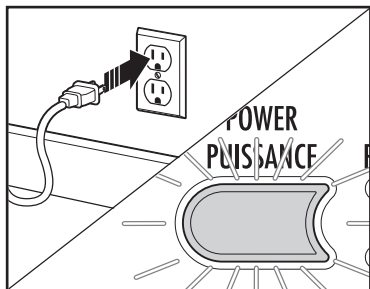

1. Plug into outlet. Red POWER Light will glow. Slide Drip Tray onto Base.

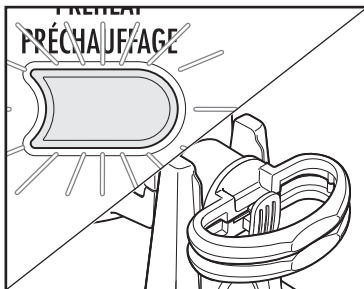

2. Preheat with Cover closed until green PREHEAT Light comes on. Pull Release Latch toward Handle to unlock.

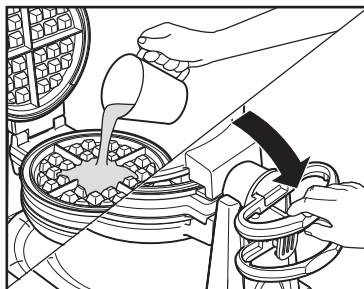

3. **To make first waffle**, lift Cover that says FILL THIS SIDE FIRST. Pour about 2/3 cup (160 ml) of batter into center of lower Grid, allowing batter to spread for even filling; then lower Cover. Be careful not to pour too much batter onto Grid to avoid overflow.

TIP: Adjust amount of batter as needed.

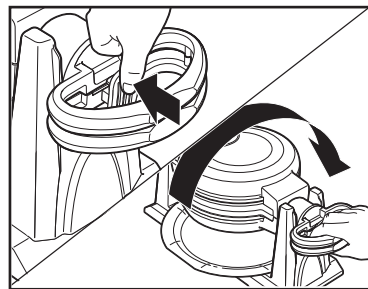

4. Within 10 seconds of closing Cover, push Release Latch toward Grid to lock and turn Handle clockwise to flip Waffle Maker. **To make second waffle**, pull Release Latch toward Handle to unlock. Raise Cover to access Lower Grid and pour about 2/3 cup (160 mL) batter into center of Lower Grid. Lower Cover, push Release Latch toward Grid to lock into place, and turn Handle counter-clockwise to flip Waffle Maker. Waffles are done in about 3 to 5 minutes, depending on recipe and when steaming begins to stop.

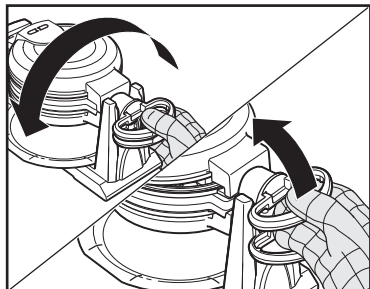

5. Using an oven mitt, pull Release Latch toward Handle to unlock. Raise Cover to check waffle doneness. Remove first waffle if done. If waffle is not done, lower Cover to continue cooking. **To remove second waffle:** Close Cover. Lock Release Latch and turn Handle clockwise to opposite side. Unlock Release Latch and raise Cover to check waffle doneness. If waffle is not done, lower Cover to continue cooking.

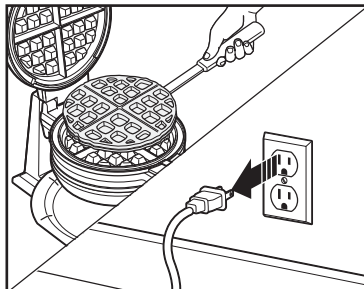

6. Remove waffle with plastic or wooden utensil. Never use metal. This will damage the nonstick coating of the appliance. Unplug unit when through cooking. Let cool.

Care and Cleaning

⚠ WARNING Electrical Shock Hazard. Disconnect power before cleaning. Do not immerse cord, plug, or base in any liquid.

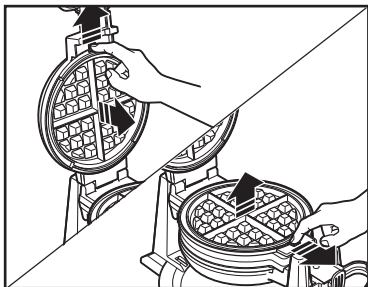

1. Unplug unit and allow to cool completely before removing Grids. To remove Grids, press Grid Release Button away from Grids, and then pull Grid out.

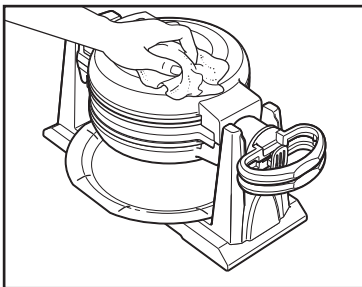

2. Wipe outside of unit with a damp, soapy cloth. Do not use steel wool, scouring pads, or abrasive cleansers on any part of the unit. Never use sharp or pointed objects for cleaning purposes.

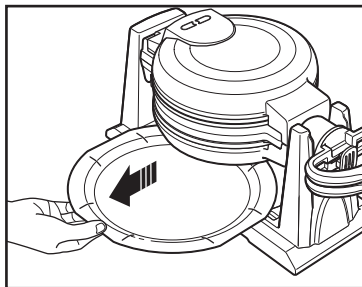

3. Clean Drip Tray by rinsing off excess overflowed batter with hot water; then use a soapy cloth to clean Drip Tray and rinse again with hot water.

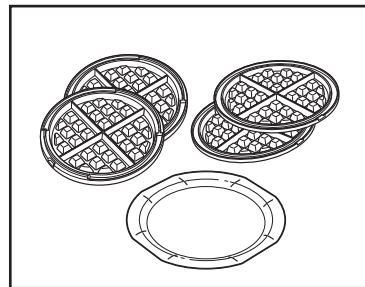

4. Wash Grids and Drip Tray in hot, soapy water or the dishwasher. DO NOT use the "SANI" setting when washing in the dishwasher. "SANI" cycle temperatures could damage your product.

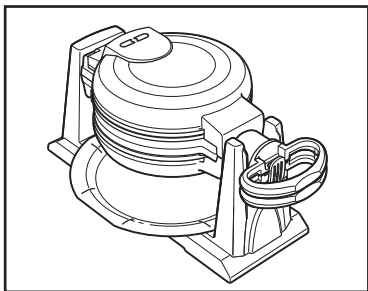

5. To reinstall Grids: Pull Release Latch toward Handle to unlock. Lift Cover, align Tabs on Grid with inserts in Cover, and press Grid to latch, sliding Grid Release Button, if necessary. Repeat with remaining Grids.

NOTE: Tabs for Grids are spaced further apart on Cover of each waffle side.

6. Always allow the appliance to cool down completely and lock Cover by pushing Release Latch toward Grids before storing.

Usage Tips

- To make your family a quick, hot breakfast, use any of the waffle mixes currently available on the market.
- Save time and prepare waffles ahead. Let cool and wrap in plastic wrap and store in an airtight container in freezer.
- Save additional time in the morning by preparing waffle batter the night before and refrigerating it. Make sure waffle batter reaches room temperature before use. Using fresh batter results in fluffier waffles.
- If your waffles start to stick, the Grids may need to be scrubbed with a nylon brush to remove any cooked-on food particles.
- If using nuts in waffle batter, use chopped nuts and/or evenly spread batter to allow Cover to fully close.
- Waffles can be made ahead of time and kept warm in a 200°F (93°C) oven.
- Most waffles are done in about 3 to 5 minutes. Some of the recipes which are made from scratch may take a little longer. Check for doneness at about 3 to 5 minutes. If Cover of Waffle Maker doesn't lift up easily, then let the waffle cook a minute more before checking again. Another indicator that the waffle is done is when steaming is reduced and stops.
- Reheat in a microwave oven, a toaster oven, or a regular oven.
- If waffles start to stick, spray a small amount of nonstick cooking spray on Grids before preheating.

Troubleshooting

Waffle Maker will not turn on or POWER Light is not illuminated.

- Check to make sure it is plugged into an electrical outlet. If not, plug into working electrical outlet.

Waffle taking too long to cook or waffle not done.

- Check recipe for waffle cooking time. Waffles are cooked when steaming stops.
- Slightly lift Cover; if waffle starts to release it is cooked. If it doesn't, continue to cook 1 to 2 minutes.

Difficulty closing Cover.

- Reduce amount of mix-ins. Nuts or chocolate chips may make the Cover difficult to close if you do not spread the batter in the unit evenly when pouring batter onto Grids.

Waffle sticking to Grids.

- Spray a small amount of cooking spray on Grids before preheating.
- Waffle isn't fully cooked. Wait until steaming stops to remove waffle.
- Grids need to be cleaned. Clean Grids after each use.

Limited Warranty

This warranty applies to products purchased and used in the U.S. and Canada. This is the only express warranty for this product and is in lieu of any other warranty or condition.

This product is warranted to be free from defects in material and workmanship for a period of five (5) years from the date of original purchase in Canada and one (1) year from the date of original purchase in the U.S. During this period, your exclusive remedy is repair or replacement of this product or any component found to be defective, at our option; however, you are responsible for all costs associated with returning the product to us and our returning a product or component under this warranty to you. If the product or component is no longer available, we will replace with a similar one of equal or greater value.

This warranty does not cover glass, filters, wear from normal use, use not in conformity with the printed directions, or damage to the product resulting from accident, alteration, abuse, or misuse. This warranty extends only to the original consumer purchaser or gift recipient. Keep the original sales receipt, as proof of purchase is required to make a warranty claim. This warranty is void if the product is used for other than single-family household use or subjected to any voltage and waveform other than as specified on the rating label (e.g., 120 V ~ 60 Hz).

We exclude all claims for special, incidental, and consequential damages caused by breach of express or implied warranty. All liability is limited to the amount of the purchase price. **Every implied warranty, including any statutory warranty or condition of merchantability or fitness for a particular purpose, is disclaimed except to the extent prohibited by law, in which case such warranty or condition is limited to the duration of this written warranty.** This warranty gives you specific legal rights. You may have other legal rights that vary depending on where you live. Some states or provinces do not allow limitations on implied warranties or special, incidental, or consequential damages, so the foregoing limitations may not apply to you.

To make a warranty claim, do not return this appliance to the store. Please call 1.800.851.8900 in the U.S. or 1.800.267.2826 in Canada or visit hamiltonbeach.com in the U.S. or hamiltonbeach.ca in Canada. For faster service, locate the model, type, and series numbers on your appliance.